

STESSO PEX WATER INSTALLATION INSTRUCTIONS

The following instructions explain the correct installation procedure for STESSO PEX fittings with STESSO PEX water pipe.

1



With a set of pipe cutters /shears cut the pipe at 90° ensuring the pipe is square on the end.

2



Place reaming tool inside pipe and rotate 360° 2 to 3 times to bevel internal wall of pipe to allow for fitting to slide into pipe without pinching 'O' ring.

3



Push fitting into pipe until pipe is visible on the three viewing ports on the stainless steel crimp ring.

4

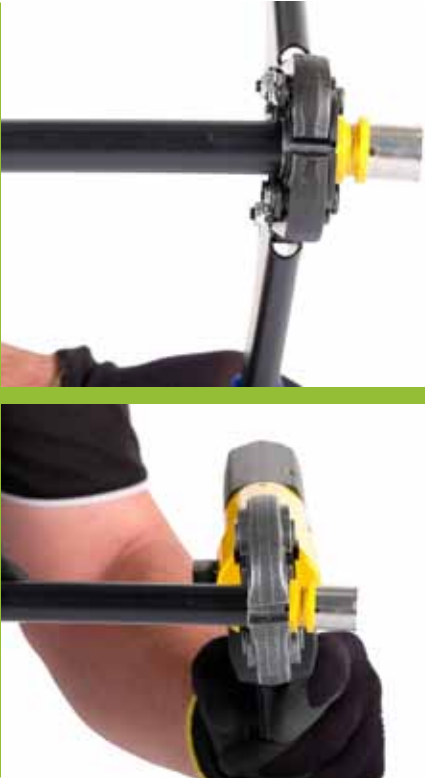

Using the STESSO crimping tool which has a 'U' profile jaw. Place tool over stainless steel crimp ring ensuring jaws are centred.

5



Proceed to crimp the fitting until jaws of tool are completely closed.

STESSO PEX WATER INSTALLATION INSTRUCTIONS CONT.

The following instructions explain the correct installation procedure for STESSO PEX fittings with STESSO PEX water pipe.

6



Stainless ring will have three visible lines if it has been crimped correctly.

At completion of installation a pressure test must be carried out in accordance with AS/NZS 3500 and or any other requirements specified by local authorities.



STESSO PEX GAS INSTALLATION INSTRUCTIONS

The following instructions explain the correct installation procedure for STESSO PEX fittings with STESSO PEX gas pipe.



With a set of pipe cutters /shears cut the pipe at 90° ensuring the pipe is square on the end.



Place reaming tool inside pipe and rotate 360° 2 to 3 times to bevel internal wall of pipe to allow for fitting to slide into pipe without pinching 'O' ring.



Push fitting into pipe until pipe is visible on the three viewing ports on the stainless steel crimp ring.

STESSO PEX GAS INSTALLATION INSTRUCTIONS

The following instructions explain the correct installation procedure for STESSO PEX fittings with STESSO PEX gas pipe.

4



Using the STESSO crimping tool which has a 'U' profile jaw. Place tool over stainless steel crimp ring ensuring jaws are centred.

5



Proceed to crimp the fitting until jaws of tool are completely closed.

6



Stainless ring will have three visible lines if it has been crimped correctly.



Battery Crimping Tool



Manual Crimping Tool